

How to help with medication for anaphylaxis

Anaphylaxis medication (epinephrine) is injected into the body with a needle. The two products available in North America are explained here. These devices are designed for simple use and give the right amount of medication with each injection. If the casualty cannot give the injection to themselves, you may have to do it.

EpiPen® or Twinject® Auto-Injector

Both auto-injectors are disposable drug-delivery systems with a spring-activated, concealed needle. An EpiPen® Auto-Injector delivers a single dose of medication. A casualty may have more than one auto-injector for multiple doses.

The Twinject® Auto-Injector delivers two doses of medication in a single device. (The second dose is delivered by a manual injection).

In both cases, it is important to be familiar with, and follow manufacturer's instructions.

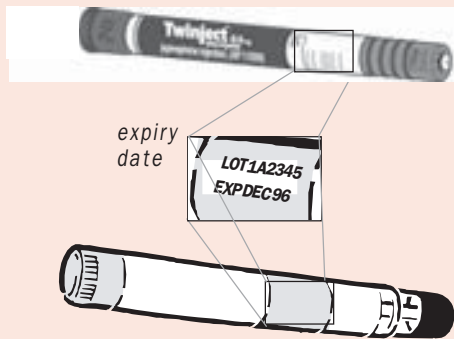

To use the Auto-Injector

- 1 hold the unit firmly, keeping your hand away from the round tip

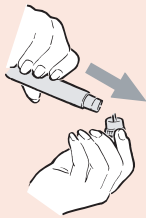

check the expiry date

Take the EpiPen® out of the storage tube and pull off the grey safety cap.

Take the Twinject® from the storage tube and remove the caps from either end (caps may be green or red and green).

- ◆ The liquid in the syringe should be clear and have no colour.
- ◆ Check the expiry date. In the event of a life-threatening allergic reaction you should use an out-of-date product if that is all you have
- ◆ It takes 2-8 lbs of pressure to activate the unit.
- ◆ If you or anyone else is injected by mistake, get medical help.

- 2 only use the auto-injector on the fleshy part of the outer thigh

auto-injectors can be given through lightweight clothing

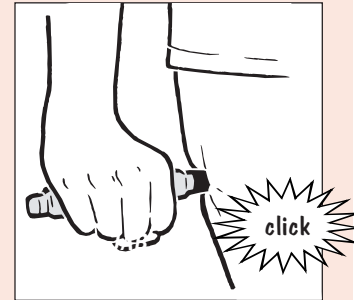

Place the black tip (EpiPen®) - grey or red for the Twinject®, against the mid-outer thigh and press firmly until the unit activates. Hold the auto-injector in place for several seconds, then pull it straight out.

- 3 After the injection, keep the casualty warm and avoid any exertion. If the casualty's condition doesn't get better in 10 minutes (or sooner), give another dose. This will require a second EpiPen® or in the case of the Twinject®, the second dose is delivered by manual injection.

Individuals who are feeling faint or dizzy because of impending shock should be placed in the shock position unless they are vomiting or experiencing respiratory distress. It is important that the casualty does not sit or stand immediately as this could cause a drop in blood pressure.

The medication will begin to wear off within 10 to 20 minutes—get medical help right away.

What to do with the Auto-Injector

Put the used unit back in the storage tube and take it to the hospital with the casualty.